

# ATLANTIC

caravans



## ENDEAVOUR LTD

### Front Loading Washing Machine



### 24" LCD TV /DVD/ Radio/ Sound-System



### Reverse Cycle Air-Con



### 100Amp Deep Cycle Battery, 120 Watt Solar Panel With Regulator

## Specifications

	17" Single	19" Dual
<b>Chassis:</b>		
4" Road Runner Chassis With 4" A-Frame	●	●
Single Axle 2000gtn	●	
Tandem Axle 2800gtn With 10" Brakes		●
Standard Suspension	●	●
15" Alloy Wheel/Tyres- All Terrain 235mm	●	●
Extend A-Frame To Fit Spare Wheel		●
Spare Wheel Fitted To Bumper Bar	●	
<b>Interior:</b>		
Drawers (All Drawers Are Steel Sided)	●	●
Drop Down Doors To End Of Dinette	●	●
Lift Lock Catches To All Doors And Drawers	●	●
Square Edge Laminex Bench Tops	●	●
Magazine Pouch At Back Of Lounge	●	●
Bed Base - Qs Lift-Up Posturepedic Splattered Base With Extension	●	●
Splashback In Kitchen And En-Suite	●	●
Mirrored Robes At Each Side Of Bed	●	●
Qs Innerspring Mattress	●	●
4 Gas Burner And Mini Grill (Thetford)	●	●
Coast To Coast Range-Hood	●	●
Microwave	●	●
Thetford 164L Fridge	●	●
2Kg Mini Front Loading Washing Machine	●	●
Air Command "Cormorant" Air Conditioning	●	●
24" Flat Screen Tv	●	●
Dvd/Cd.mp3/Radio Player & 2 Speakers	●	●
<b>Exterior:</b>		
Dometic Double-Glazed Windows With Build In Roller Blind & Screen	●	●
2 X Access Doors - To Tunnel Boot	●	●
External Picnic Table	●	●
Awning - Roll Out	●	●
Midi Heki Hatch	●	●
2 X Power Hatches	●	●
Front & Side Checker Plate (Silver or Black) - 200Mm	●	●
Triple Lock Security Door	●	●
<b>Electrical:</b>		
Led Lights Through Out	●	●
100A Deep Cycle Battery	●	●
1x120w Solar Panel 30A Regulator	●	
12 Pin Flat Plug + Anderson Plug	●	●
Charger / Transformer With Fuse Box Fitted To OHC	●	●
Digital (Ufo) Tv Antenna Ext. Tv Point; External 12v Plug - Door Side	●	●
Single P/Point Each Side Of Bed	●	●
Double P/Point Fitted In Kitchen, Bathroom and Lounge	●	●
Water Tank Gauge	●	●
<b>Plumbing:</b>		
Suburban Gas And Electric H.w.s.	●	●
Flick Mixer Taps - Through Out	●	●
2 X 9Kg Gass Bottles Fitted On A-Frame	●	●
2 X 95L Water Tanks	●	●
Shurflo 12V Pump Fitted	●	●
Adjustable Shower Rose On Flexi Hose	●	●

Flick Mixer Shower And Sink Tap	●	●
Ceramic Vanity Basin	●	●
Thetford Cassett Toilet	●	●
Water Tap To A-Frame	●	●
Single Bowl Stainless Steel Kitchen Sink	●	●
<b>Optional Extras (Available To Be Fitted To This Van)</b>		
2 Door Thetford 184Ltr Fridge	○	○
Full Oven In Lieu Of Mini Grill	○	○
Gas Bayanette	○	○
Alko ESC	○	○
External Speakers	○	○

\*These specifications apply to all 2015 model vans purchased between the 19th of January to 31st of December 2015

● Standard ○ Optional

## Endeavour Layouts

### 19' X 7'9" DUAL AXLE

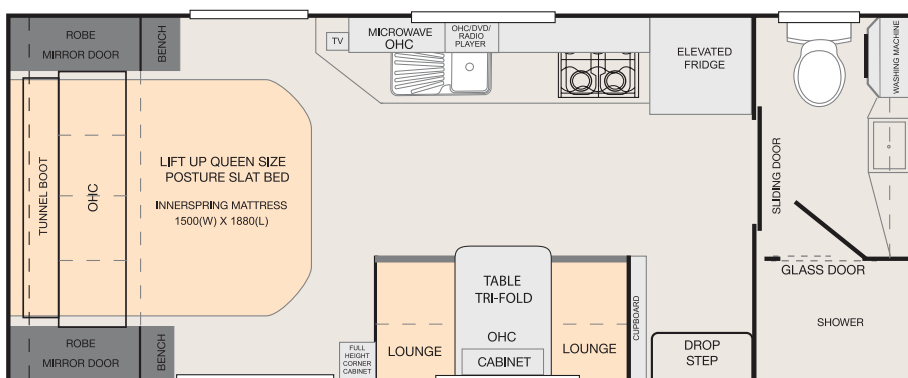

### 17' X 7'9" SINGLE AXLE

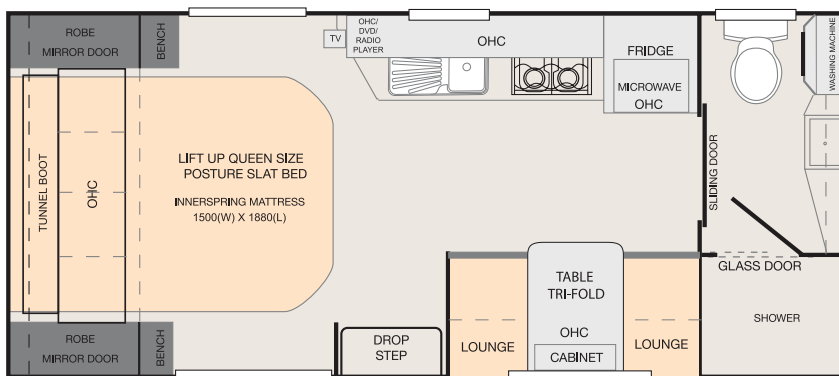

**ATLANTIC**  
caravans